



**Specifications for: One (1) 1 ton Step Van,**

**Minimum G.V.W.R of 6500 kg**

**Inquiries: Jamie Rand, Public Works Department Mechanic – 250-746-5321 Ext. 4**

Tenders are requested for the supply and delivery of one 2017/2018 Commercial type Step Van, Two Wheel Drive, with an Automatic Transmission. Tenders are to be received no later than 1:00 p.m. on Friday, September 29, 2017, and can be submitted to the City of Duncan Public Works Yard, 1091 Marchmont Road, or by fax at 250-746-5898. Prices quoted are to be F.O.B. City of Duncan Works Yard, and are to be valid for 30 days from the date of the tender closing.

Deviations from the specifications must be detailed by the tenderer. Expected time of delivery from date of purchase order is to be stated.

Quotation to be signed and submitted in a sealed envelope marked **“Tender for 2017/2018 1 ton Step Van”** and shall be addressed to Mr. Len Thew, Operations Manager.

The lowest or any other tender may not be accepted and the awarding of the tender will be based on a full review and analysis of features, delivery, references, warranty, conformity to specifications, operator acceptance, machine performance, parts and service availability, as well as overall net price.

Dealers are invited to tender any in stock or readily available units which closely match the enclosed specifications, either in lieu of the attached tender or an optional quotation.

### **Performance Criteria:**

It is anticipated that this van will be used year round. It will be used by our Waterworks Crew on a daily basis. The intended application for this van within the City of Duncan can be characterized as moderate in relation to other municipal and utility operations. This van is considered **essential** within our operation and as such “uptime” and “van reliability” have the utmost importance.

Fuel efficiency, operator comfort, capacities and performance, will factor into decision making. Warranty and warranty location will also be factors.

### **Demonstration of Van:**

The City of Duncan reserves the right to require demonstration of a van similar to that being bid; either prior to closing or subsequent to closing and before Council awards the tender. Costs associated with transportation of either the van, or the City of Duncan’s operators, are to be covered by the bidder.

### **Parts and Service Guarantees:**

Describe performance guarantees related to the provision of parts and service complete with minimum standards of the following (including costs):

- Years of servicing equipment
- Number of factory trained technicians
- Parts availability within 24 hours
- Warranty repairs within 48 hours (with some exceptions)

### **Availability Guarantees:**

Describe what availability guarantees you propose, if any. Include all costs associated with these guarantees.

As an example, if the van is down due to mechanical failure or delay in receiving parts that result in the van not being able to be operated, do you provide a backup unit? If so, what terms would be associated with doing so.

**Commercial – 1 ton Step Van  
(with a *minimum* G.V.W.R. of 6500 kg)**

Tenders are requested for the supply and delivery of one (1) 2017/2018 or (demonstrators may be considered), commercial type Step Van.

Tenderers **MUST** show **all** options available in regards to the fuel and engine type available, for example, diesel, gas, propane, hybrid etc.

Any deviations from these specifications, which, in the opinion of the City of Duncan, does not affect the overall requirements of the unit, may be considered.

Tenderers must complete **yes** or **no**, and state **all** specifications if other than as shown on tender document.

<b>VAN BODY:</b>	
<ul style="list-style-type: none"> <li>• Min. 14 feet in length from driver's seat to rear door</li> <li>• Max. 96 inches in width</li> <li>• Min. 79 inches in height inside dimensions</li> <li>• Skirted with fuel door access and rubber fenderette or skirt trim to cover rear wheels</li> </ul>	
<b>MIRRORS:</b>	
<ul style="list-style-type: none"> <li>• Velvac universal wide angle mirrors</li> <li>• Velvac part # 721090</li> <li>• Heated</li> <li>• Power</li> </ul>	
<b>VAN BODY:</b>	
<ul style="list-style-type: none"> <li>• One piece, aerodynamic molded fibreglass hood. Forward tilting with wrap-around silver or white front bumper</li> </ul>	

<b>FRONT DOORS:</b>	
<ul style="list-style-type: none"> <li>• Sliding front cab doors. 31" opening</li> <li>• Each door comes with a slider window that opens so front of window will open, (opens to rear)</li> <li>• Aluminum checker plate inside step(s)</li> <li>• Door handles to be lockable with keys</li> <li>• Grab handles for safe entry/exit</li> </ul>	
<b>REAR DOORS:</b>	
<ul style="list-style-type: none"> <li>• Double doors. Primary to be 30"W Secondary to be 20"W. One (1) 12"x18" glass window in primary door. Window to be protected by aluminum mesh screens. Face lined with aluminum.</li> <li>• 3/16" Aluminum step at rear doors</li> <li>• Door hardware to consist of Kason 2 point "freezer style" handle with slam style latches and inside release on right hand side door. Slam style latches with inside and outside handles on the left hand door. Handles to be lockable with a key. Mechanical door hold-open latches.</li> </ul>	
<b>EXTERIOR LIGHTING:</b>	
<p>All lighting to meet BC Motor Vehicle Act. All lighting to be LED</p> <ul style="list-style-type: none"> <li>• One (1) pair of 4" round stop/tail/turn LED lights</li> <li>• One (1) pair of upper 4" round stop/tail/turn LED lights to be visible through rear windows</li> <li>• Two (2) 4" round LED reverse lights</li> </ul>	

<ul style="list-style-type: none"> <li>• Three (3) LED flood lights, 2 mounted at rear corners near roof, one recess mounted mid-body curb side with dash switch, with indicator light</li> <li>• Rear door activated LED ribbon lighting for inside work area</li> <li>• Each compartment is to have its own door activated LED lighting</li> <li>• Work area lighting and cabinet lighting powered by auxiliary batteries</li> </ul>	
<p><b>EXTERIOR HAZARD LIGHTING:</b></p>	
<ul style="list-style-type: none"> <li>• Two (2) low profile, LED low profile beacon lights, minimum 16" long, with switch in the cab with indicator light. One mounted centre front below the roof line, above the windshield. The other light bar is to be mounted on the rear roof edge above the centre clearance lights.</li> </ul>	
<p><b>REAR BUMPER &amp; HITCH:</b></p>	
<ul style="list-style-type: none"> <li>• Step style rear bumper black undercoated</li> <li>• Flip out style step painted safety yellow</li> <li>• Hitch receiver reinforced to chassis frame rails</li> <li>• (1) 7prong (Pollack 12-707) and (1) 4prong (ColeHersee 1232) trailer plug receptacles installed in the bumper</li> </ul>	
<p><b>SEATING:</b></p>	
<ul style="list-style-type: none"> <li>• Driver's seat is to be fully adjustable (height/lumbar/forward &amp; reverse) , high back with arm</li> </ul>	

<p>rests</p> <ul style="list-style-type: none"> <li>• 2 Seat bench seat for passengers</li> <li>• Retractable seat belts</li> <li>• Seats and seat belts must meet B.C. MVA and B.C. OHS requirements</li> </ul>	
<b>INTERIOR ACCESSORIES:</b>	
<ul style="list-style-type: none"> <li>• Partition 14 gauge insulated and double lined</li> <li>• Air Conditioned cab</li> <li>• Front heater/defroster/3spd fan</li> <li>• Rear heater 8000 btu</li> <li>• Rear heater ducted to heat the front cab and rear compartment</li> <li>• Heater to be mounted on floor behind the partition (left side)</li> <li>• A boot drying rack over the rear heater</li> <li>• Dual wipers, 2 speed with intermittent wiper operation</li> <li>• (2) 12V power points in centre of dash</li> <li>• (3) LED dome lights (Trucklite 80251C) in cab area, one each over the driver and passenger seat and one in the centre, with a dash mounted switch</li> <li>• AM/FM radio with 2 speakers</li> <li>• Sun visors</li> <li>• (1) Trailer brake control on dash (Tekonsha Primus IQ 90160) or better and wired to trailer plug</li> <li>• (2) cab fans with 2 speed switches in their bases, mounted at top front corners of the cab that turn off with the key</li> <li>• Laptop computer mount on top of</li> </ul>	

the dash in front of the passenger seat	
<b>INSULATION/LINING:</b>	
<ul style="list-style-type: none"> <li>• 1" Urethane insulation in walls and 1.5" in ceiling</li> <li>• 1" Urethane spray foam under floor</li> <li>• Extra insulation to be put on the underside of the engine cover and on the underside of the floor on both sides of the engine cover</li> </ul>	
<b>INSULATION/LINING:</b>	
<ul style="list-style-type: none"> <li>• Extra insulation on the firewall (sound attenuation)</li> <li>• Extruded aluminum flooring</li> <li>• Complete 3/9" plywood interior lining</li> <li>• Interior to be painted white with one coat primer and one coat premium oil based eggshell white paint</li> </ul>	
<b>EXTERIOR PAINT:</b>	
<ul style="list-style-type: none"> <li>• Entire body to be properly painted white</li> <li>• Frame/chassis is to be undercoated</li> </ul>	
<b>GENERAL ITEMS:</b>	
<ul style="list-style-type: none"> <li>• Back-up alarm</li> <li>• Back-up camera</li> <li>• Sturdy cone holder mounted in front of forward bumper</li> <li>• Rubber one piece floor mat "secured" to entire floor in the cab</li> </ul>	
<b>ENGINE:</b>	
List all engine options available <ul style="list-style-type: none"> <li>• Gas</li> </ul>	

<ul style="list-style-type: none"> <li>• Diesel</li> <li>• Propane</li> <li>• Other</li> <li>• Block Heater</li> </ul>	
<b>TRANSMISSION:</b>	
<ul style="list-style-type: none"> <li>• Fully automatic</li> <li>• Transmission cooler</li> </ul>	
<b>DRIVER TRAIN/BRAKES:</b>	
<ul style="list-style-type: none"> <li>• Must be 4 wheel disc</li> <li>• State size of rotors</li> <li>• State how many pistons per caliper</li> <li>• Power assisted</li> </ul>	
<b>FRONT AXLE:</b>	
<ul style="list-style-type: none"> <li>• Type</li> <li>• Suspension</li> <li>• Full power assist steering</li> <li>• Tilt steering column</li> </ul>	
<b>REAR AXLE:</b>	
<ul style="list-style-type: none"> <li>• Dual wheel</li> <li>• Ratio</li> <li>• Suspension</li> </ul>	
<b>EMERGENCY BRAKE:</b>	
<ul style="list-style-type: none"> <li>• State type of emergency brake</li> </ul>	
<b>TIRES:</b>	
<ul style="list-style-type: none"> <li>• Steer tires (size &amp; type)</li> <li>• Drive tires (size &amp; type)</li> </ul>	
<b>EXTERIOR COMPARTMENTS:</b>	
** see attached drawings**	
<ul style="list-style-type: none"> <li>• All are to be constructed of aluminum, 1/8" thickness (minimum), vented, stainless hinges and lockable</li> <li>• Compartment #1 <ul style="list-style-type: none"> <li>○ Is intended to store shovels, rakes, brooms and should be</li> </ul> </li> </ul>	



<p>a minimum of 6' tall x 36" wide, with a depth being the same as bench</p> <ul style="list-style-type: none"> <li>• <b>Compartment #2</b> <ul style="list-style-type: none"> <li>○ Is intended to store gas powered cut-off saw and 12 volt submersible "deluge" pump and hose</li> </ul> </li> <li>• <b>Compartment #3</b> <ul style="list-style-type: none"> <li>○ Will store electric Hilti TE3000 Jackhammer. Rough Dimensions are 41.5" tall, 24" width across handle, 16" wheel width on transporting cart</li> </ul> </li> <li>• <b>Compartment #4</b> <ul style="list-style-type: none"> <li>○ Will store gas powered TA65 (APT) Jumping Jack; Dimensions are 42.5" tall and handle is roughly 28.5" x 13.5"</li> </ul> </li> <li>• <b>Compartment #5</b> <ul style="list-style-type: none"> <li>○ Is intended to store "water keys" (T handle type keys that are 3' x 6')</li> <li>○ Access to this compartment shall be from the inside</li> </ul> </li> </ul>	
<p><b>INVERTER/CHARGER (Auxiliary Batteries):</b></p>	
<ul style="list-style-type: none"> <li>• 12 volt inverter/charger to run Hilti Jackhammer</li> <li>• Inverter must be capable of running jackhammer for extended periods of time</li> <li>• Auxiliary batteries are to be isolated from chassis battery(ies) and are to be deep cycle</li> </ul>	

<ul style="list-style-type: none"> <li>• Auxiliary batteries will power LED beacon lights</li> <li>• 110 volt G.F.I. outlet at work bench</li> <li>• 110 volt G.F.I. outlet at rear outside area of van for powering Hilti Jackhammer</li> <li>• One male "shore" power plug, wired to a power bar, for charging tools and equipment over night. Wired to bench area</li> </ul>	
<b>OTHER:</b>	
State warranty repair location - must be no further from the City of Duncan Works Yard than Nanaimo or Victoria	
State any extra cost if warranty repairs are carried out at our door (1091 Marchmont Road, Duncan)	
State parts inventory location	
Note any guaranteed parts supply programs available and associated cost	
<b>MANUALS:</b>	
<ul style="list-style-type: none"> <li>• Operator Manual</li> <li>• Parts Manual</li> <li>• Service Manual</li> </ul> <p>*all at time of delivery*</p>	
Safety and operator training video	
<b>DEMONSTRATION:</b>	
The City of Duncan may require the tenderer to allow employees of the City to operate on our site, similar to the one bid, prior to final decision	

Note any specific features which the manufacturer identifies as being specific advantages of the above machine:	
Please include manufacturer's brochures	

and full specifications.	
--------------------------	--

<b>DELIVERY:</b>	
State expected delivery from date of purchase order. Date of delivery may be used as criteria in determining the successful tender. <b>Supply prior to December 15, 2017 is essential/required.</b>	

<b>PRICE:</b>	
Base price as specified:	
Environmental levies:	
Taxes:	
<b>TOTAL F.O.B. City Public Works Yard (1091 Marchmont Road, Duncan, BC)</b>	
<b>Options:</b> Note any price of any options, as recommended by manufacturer or dealer, for example, engine options, chassis options	
<b>(A)</b>	
<b>(B)</b>	
<b>(C)</b>	
<b>(D)</b>	
Subtotal Options:	
Options Additional PST:	
Options Additional GST:	
Total of Options including taxes:	

<b>DEALER NAME:</b>	
<b>ADDRESS:</b>	
<b>PHONE NUMBER:</b>	
<b>FAX NUMBER:</b>	
<b>EMAIL:</b>	
<b>REP. NAME AND SIGNATURE</b>	
<b>DATE:</b>	
<b>EXPIRY OF QUOTE:</b>	

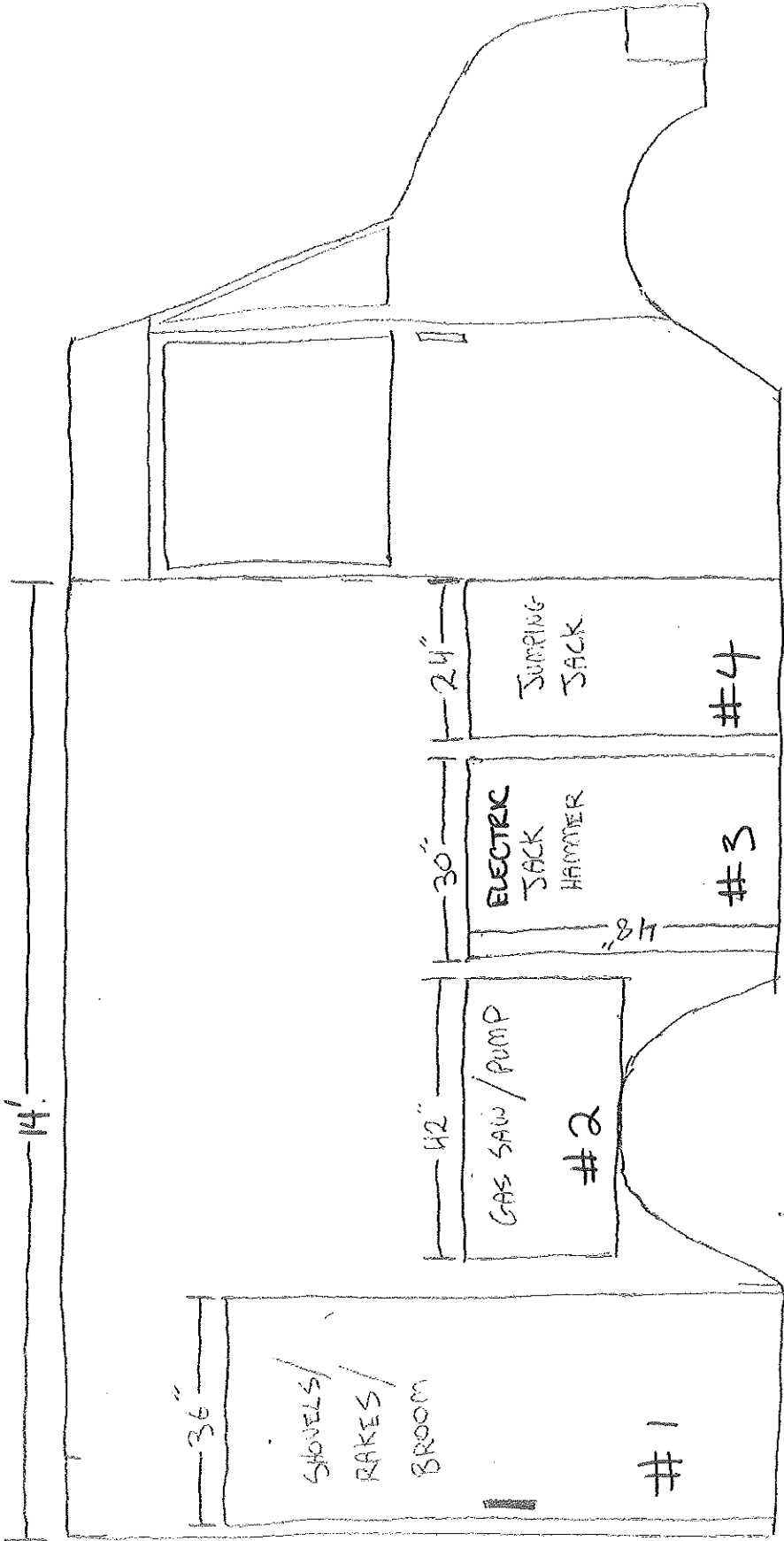

PASSENGER VIEW

# ABOVE VIEW

