

REPAIR LOCATION #1 (3 LOCATIONS)

Sewer ID#269

REPAIRS AT 0.8M, 13.8M NORTH OF SMH220 AND 1.3M SOUTH OF SMH386

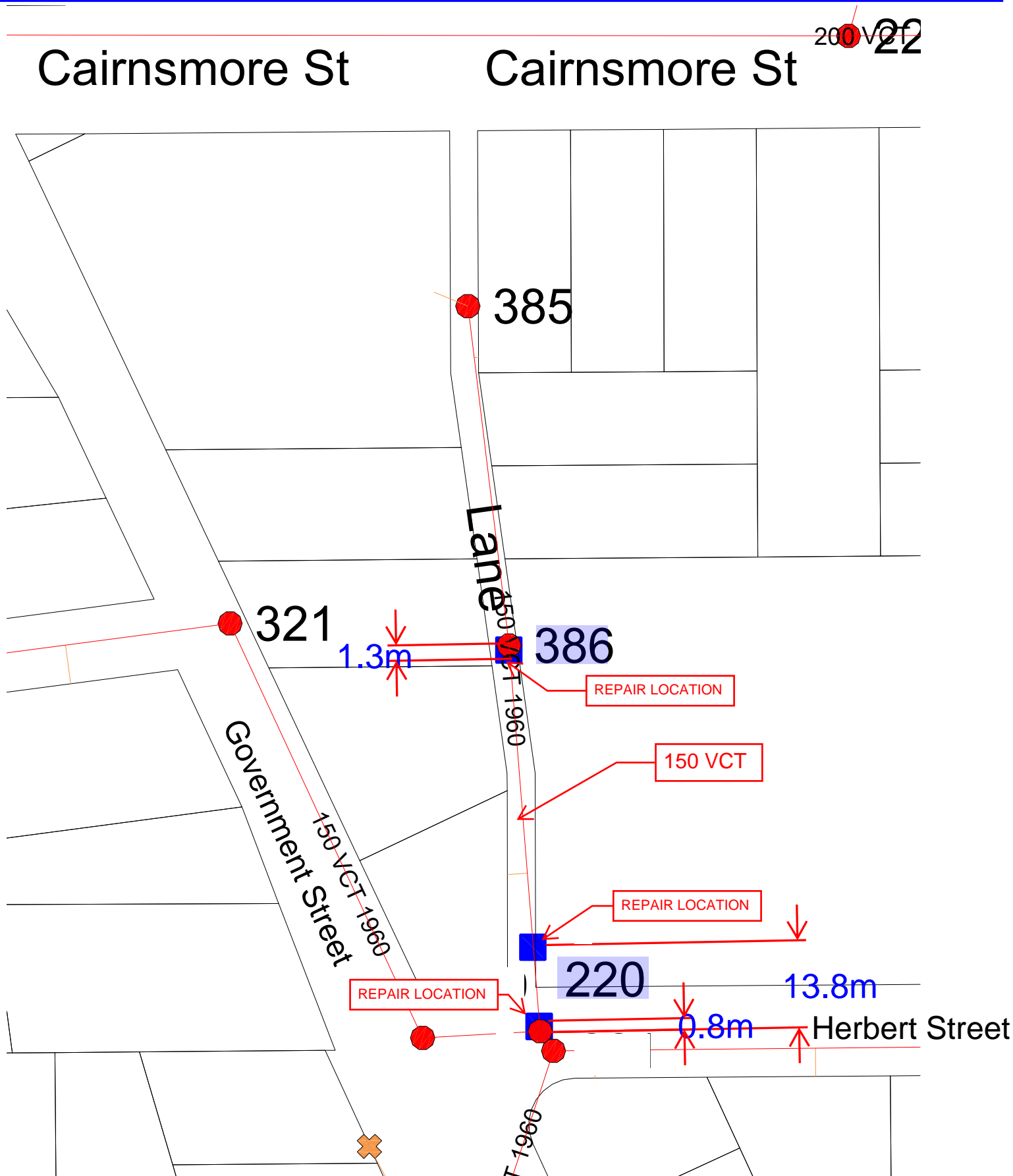

REPAIR LOCATION #2 (3 LOCATIONS) SEWER ID#87
REPAIRS AT 48M AND 58-60M NORTH OF SMH82
AND 12M-14M SOUTH OF SMH76

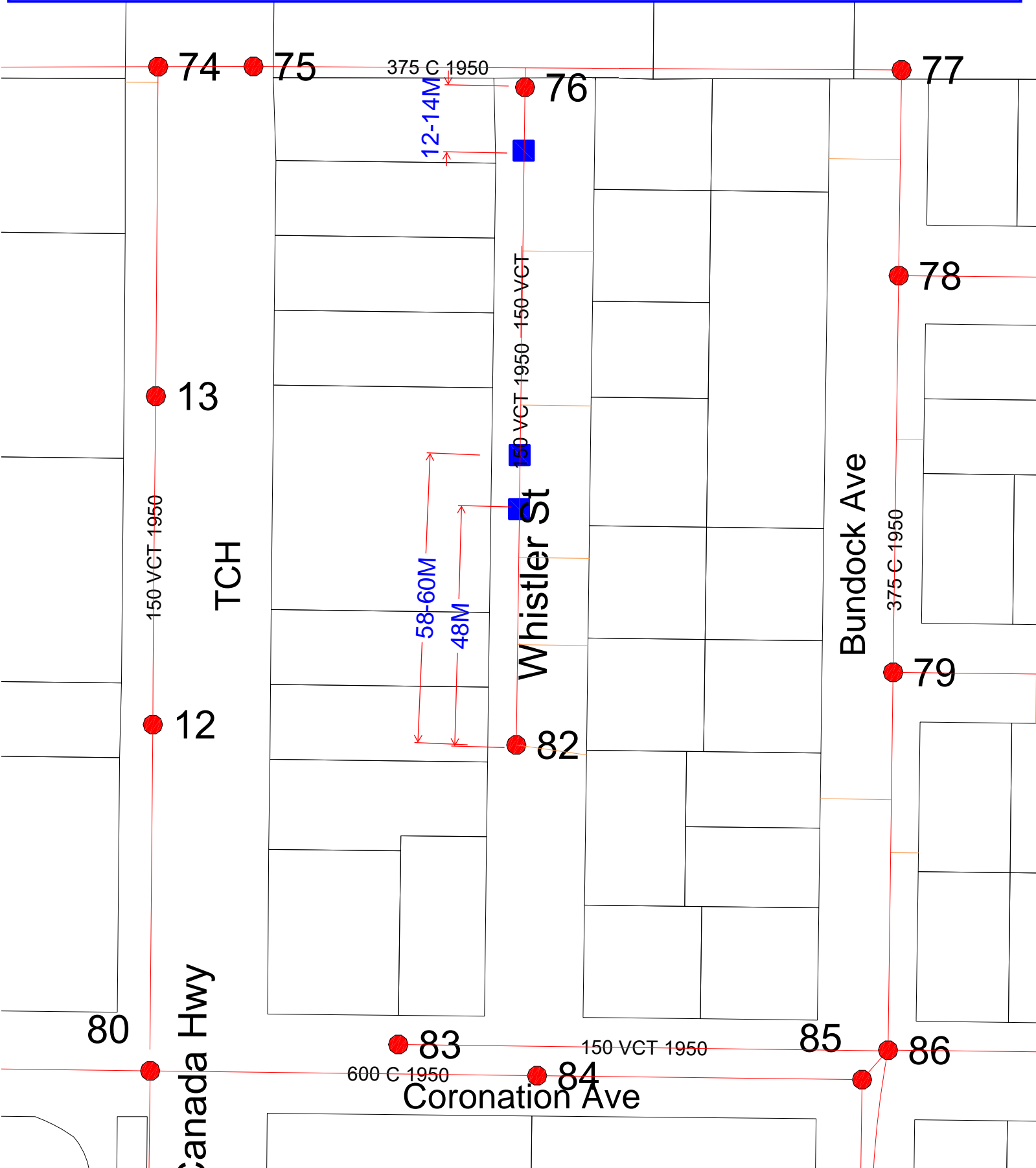

REPAIR LOCATION #3 SEWER ID#303

REPAIR AT 1M WEST OF SMH277

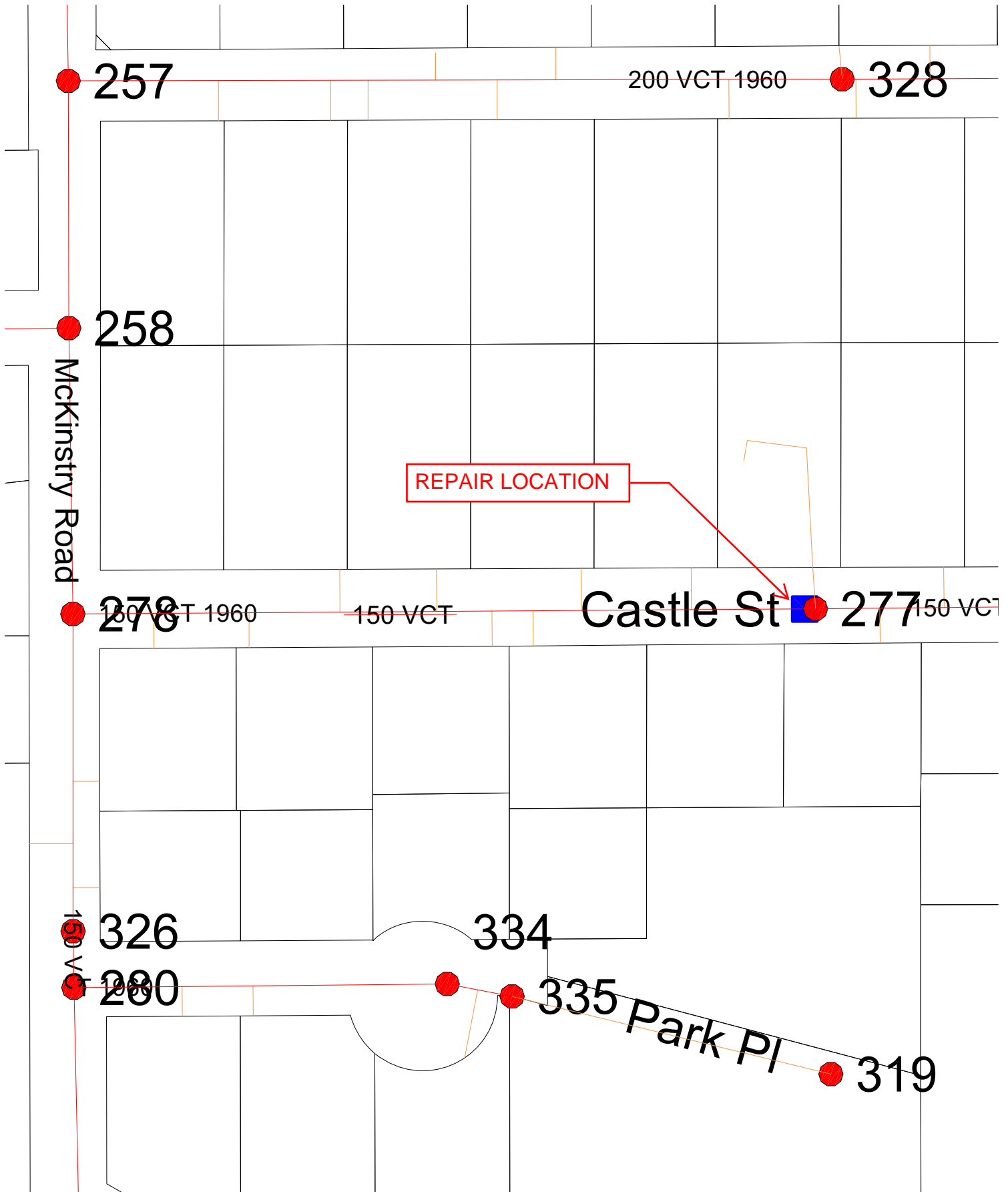

REPAIR LOCATION #4 SEWER ID#9
remove and replace 6.0 meter section

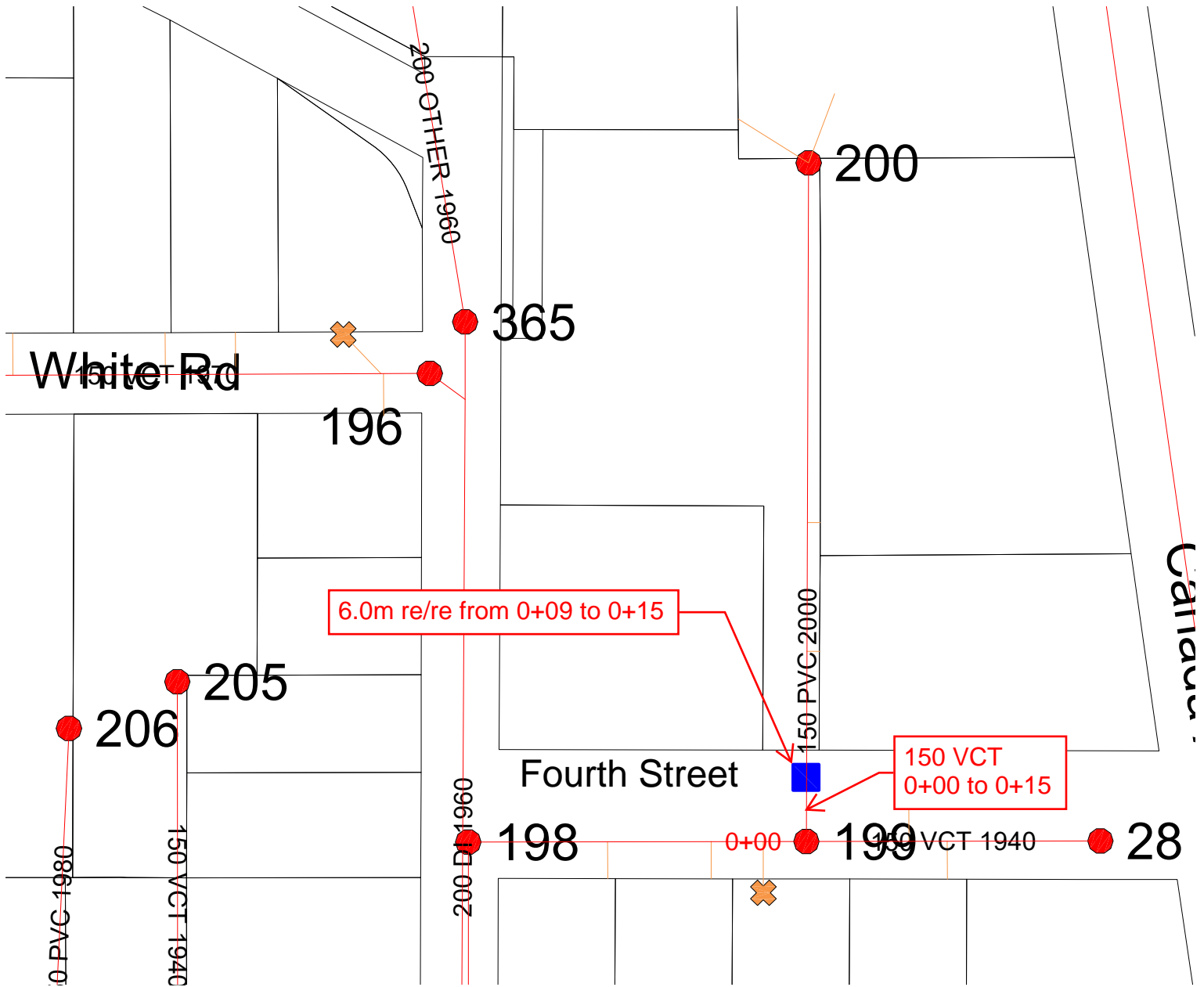

REPAIR LOCATION #5 SEWER ID#199 AND ID#200 repairs required at 1.0m and 4.5m east of SMH 158 and 19.8m west of SMH 158

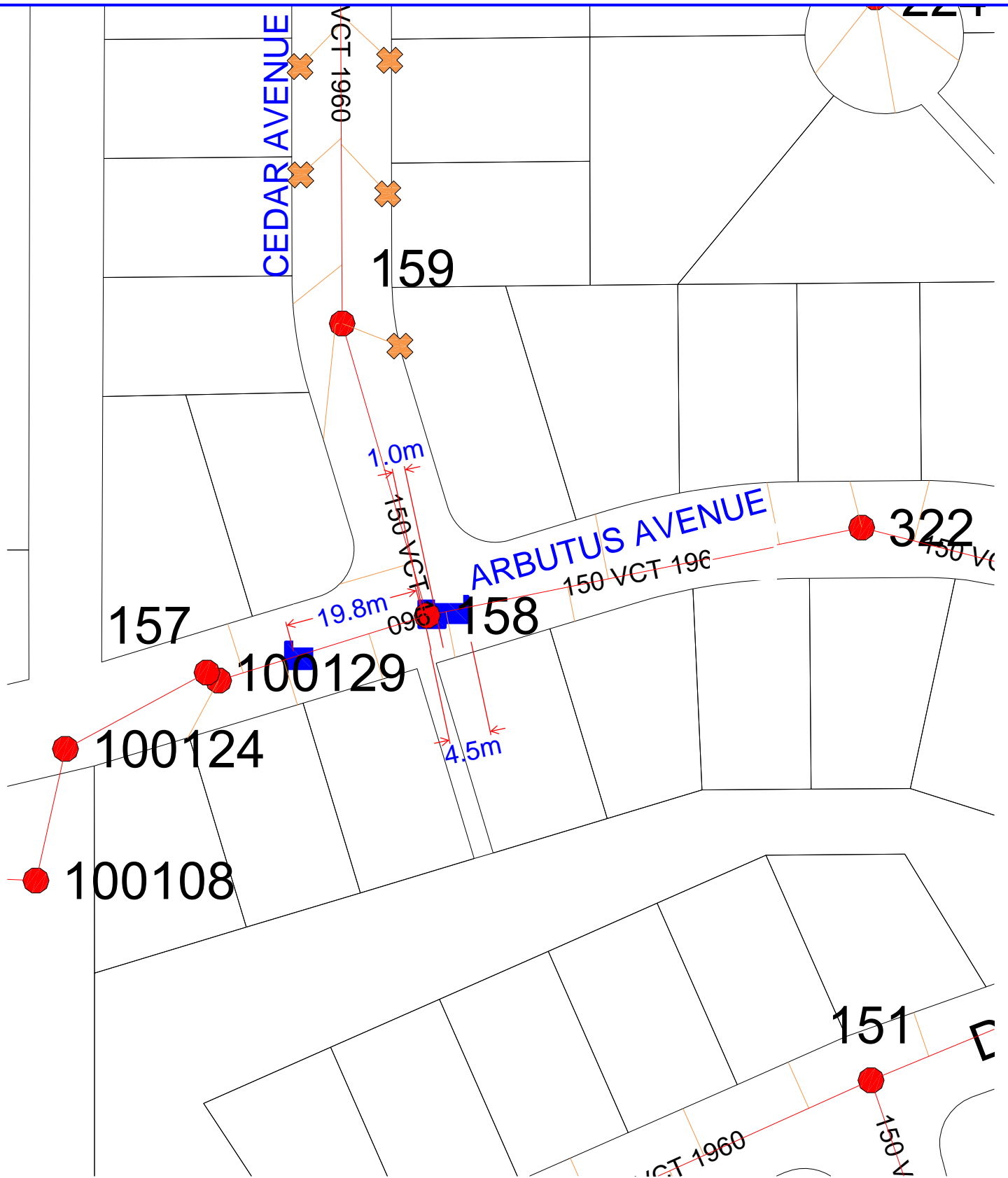

REPAIR LOCATION #6 SEWER ID#202

repairs required at 6.6m and 7.1m west of SMH 167
and 1.5m east of SMH 148

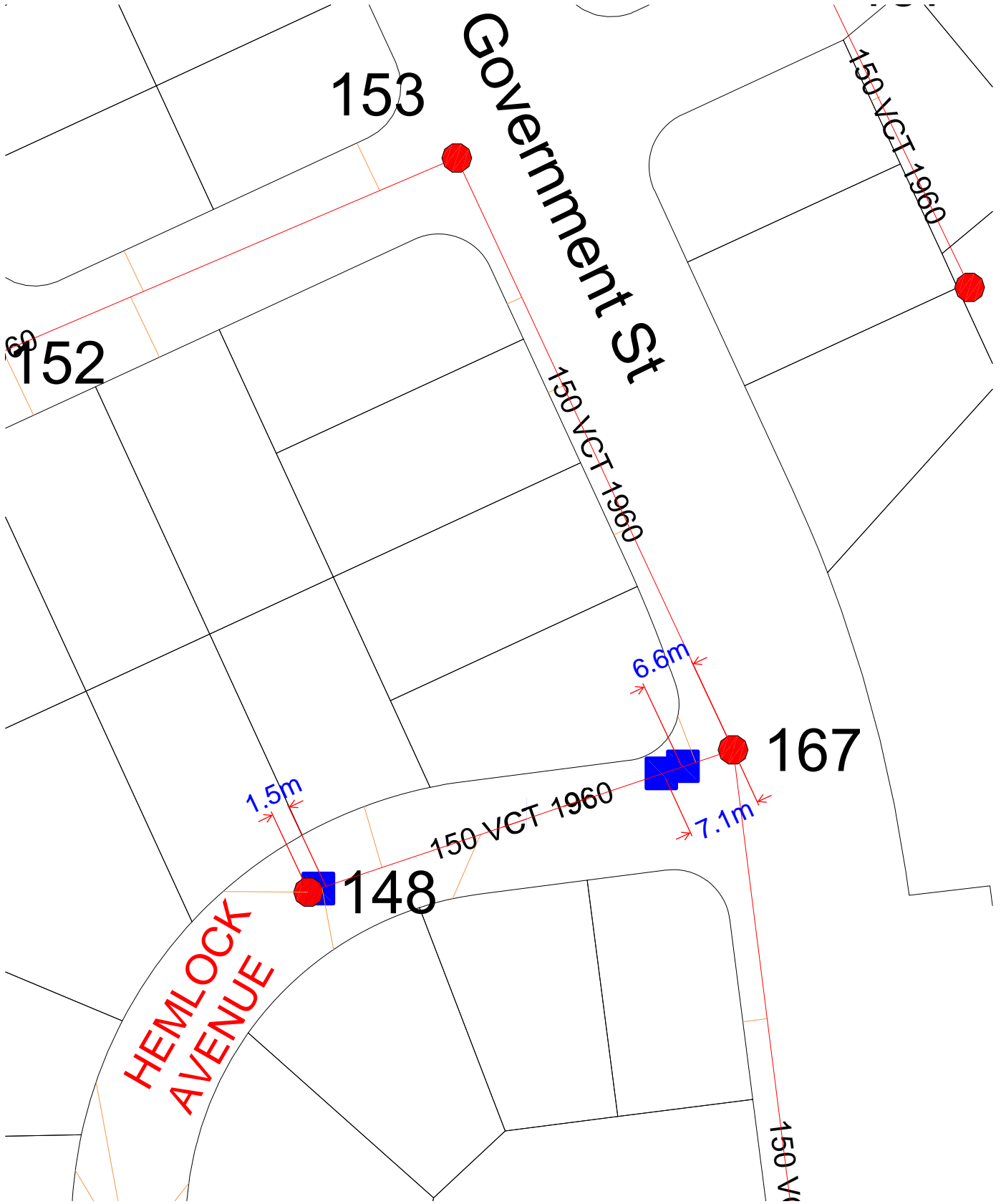

REPAIR LOCATION #7 SEWER ID#115

repairs required at 60.4m and from 73.0m to 75.0m east of SMH 112

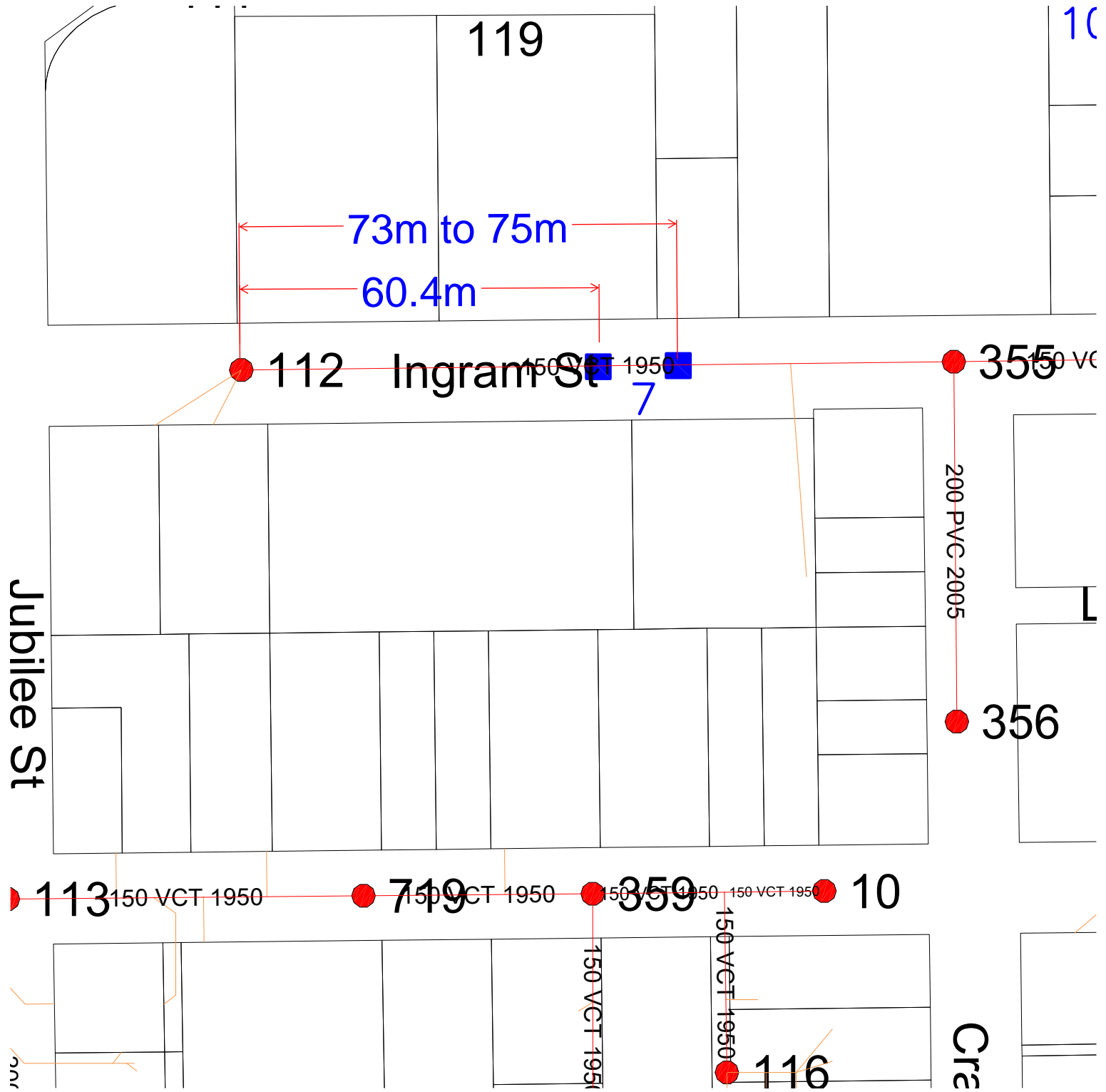

REPAIR LOCATION #8

SEWER ID#73

repairs required at 1.5m, 63.4 to 65.1 and from 73.0m to 75.0m south of SMH 62

