

KOMPAN COROCORD 3030 - MINI SPACENET
SUPPLIED AND INSTALLED BY RECTEC INDUSTRIES
-1-800-667-8141



10'8' HIGH BIG TOYS INLINE SWING SUPPLIED AND INSTALLED BY RECTEC INDUSTRIES
1-800-667-8141

SCOPE OF WORK:

- 1) RELOCATE TWO EXISTING TREES AS SHOWN INCLUDING DRIP LOOP IRRIGATION.
- 2) PROVIDE A SHOP DRAWING AND RELOCATE EXISTING IRRIGATION HEADS AND PIPE AS REQUIRED TO ACCOMMODATE PLAYGROUND ADDITION AND PROVIDE IRRIGATION TO EXISTING LAWN AREA.
- 3) EXCAVATE AND DISPOSE OF SURPLUS MATERIALS TO THE GRADES SHOWN ON THE DRAWINGS FOR THE PLAYGROUND EDGER AND SAFETY SURFACE.
- 4) INSTALL DRAINAGE STRUCTURE AS SHOWN ON THE DRAWINGS.
- 5) INSTALL CONCRETE PLAYGROUND EDGER AS SHOWN ON THE DRAWINGS.
- 6) COORDINATE WITH PLAYGROUND EQUIPMENT INSTALLER. PLAYGROUND FOOTINGS, EQUIPMENT AND SAFETY SURFACE TO BE INSTALLED BY RECTEC INDUSTRIES 1-800-667-8141.
- 7) BACKFILL PLAYGROUND EDGER WITH GROWING MEDIUM, FINE GRADE AND SEED.
- 8) CLEAN UP.

NOTES:

- 1) DO NOT SCALE DRAWINGS: VERIFY ALL PROPERTY LINES, ELEVATIONS AND EXISTING STRUCTURES TO REMAIN PRIOR TO CONSTRUCTION.
- 2) CONTRACTOR TO MAINTAIN EXISTING IRRIGATION SYSTEM OPERATION AND MODIFY AS REQUIRED. CONTRACTOR TO PROVIDE A SHOP DRAWING OF THE MODIFIED IRRIGATION SYSTEM AND AS BUILT DRAWING PRIOR TO INSTALLATION. OVER SPRAY OF PLAYGROUND SAFETY SURFACE IS PERMITTED.
- 3) IRRIGATION COMPONENTS LOCATED IN THE FOOTPRINT OF THE NEW SAFETY SURFACE CAN STAY IN THAT LOCATION IF THEY ARE OUTSIDE OF THE SAFETY ZONE (DOTTED LINES AROUND TOYS). ANY IRRIGATION LINES CAN ALSO STAY IN THE SAFETY SURFACE AS LONG AS THEY GO AROUND THE FOOTINGS AND ARE BELOW THE DEPTH OF THE FIBAR (WOOD CHIPS).
- 3) REFER TO DETAIL 1/L01 FOR PLAYGROUND EDGE DETAIL AND DEPTH OF SAFETY SURFACE. EXCAVATED SURPLUS MATERIAL SHALL BE REMOVED FROM THE SITE.
- 4) ALL WORKS SHALL BE INSTALLED AS PER MMCD SPECIFICATIONS.
- 5) ALL DISTURBED LANDSCAPE AREAS ADJACENT TO NEW WORK SHALL BE FEATHERED OUT TO EXISTING GRADE WITH IMPORTED GROWING MEDIUM AND SEEDED TO LAWN.
- 6) PLAYGROUND FOOTINGS, EQUIPMENT AND SAFETY SURFACE SHALL BE INSTALLED BY OTHERS.
- 7) CONTRACTOR SHALL CLEAN UP AND MAKE GOOD ANY DAMAGE CAUSED BY HIS WORK TO ACCESS AND COMPLETE THE WORKS AT THIS SITE.. NOTABLY TOP DRESSING ANY RUTS IN THE EXISTING LAWN AND SEEDING.
- 8) APPROXIMATE LOCATIONS OF WATER, ELECTRICAL AND IRRIGATION LINES ARE SHOWN ON THE DRAWINGS. THE CONTRACTOR SHALL LOCATE AND TAKE THE NECESSARY STEPS TO PROTECT THE UNDERGROUND UTILITIES AND MAKE GOOD ANY DAMAGE TO SAME. NOTE THE SITE HAS POOR SUBGRADE MATERIALS WHICH BECOME VERY SOFT AFTER PROLONGED RAIN.
- 8) TWO TREES HAVE TO BE RELOCATED AS SHOWN PRIOR TO STARTING WORK. THE TREES SHALL BE PLANTED AS PER THE DETAIL 2/L01 AND MAINTAINED UNTIL CONTRACT COMPLETION.

SEED MIX
GRASS SEED MIX
10% IMPACT KENTUCKY BLUEGRASS,
10% AWARD KENTUCKY BLUEGRASS, 80% CHAMPION BLEND GQ RYEGRASS
(SR 4500, SR 4420 AND SR 4220)

SEED RATE
4 KG PER 100 SQ. M.
PROPOSED FERTILIZER AND LIME
EVERGROW QUICK START 13-26-6 AT THE RATE OF 4KG PER 100 SQ. M.
SPREADEASY DOLOMITE LIME AT THE RATE OF 12KG PER 100 SQ. M.

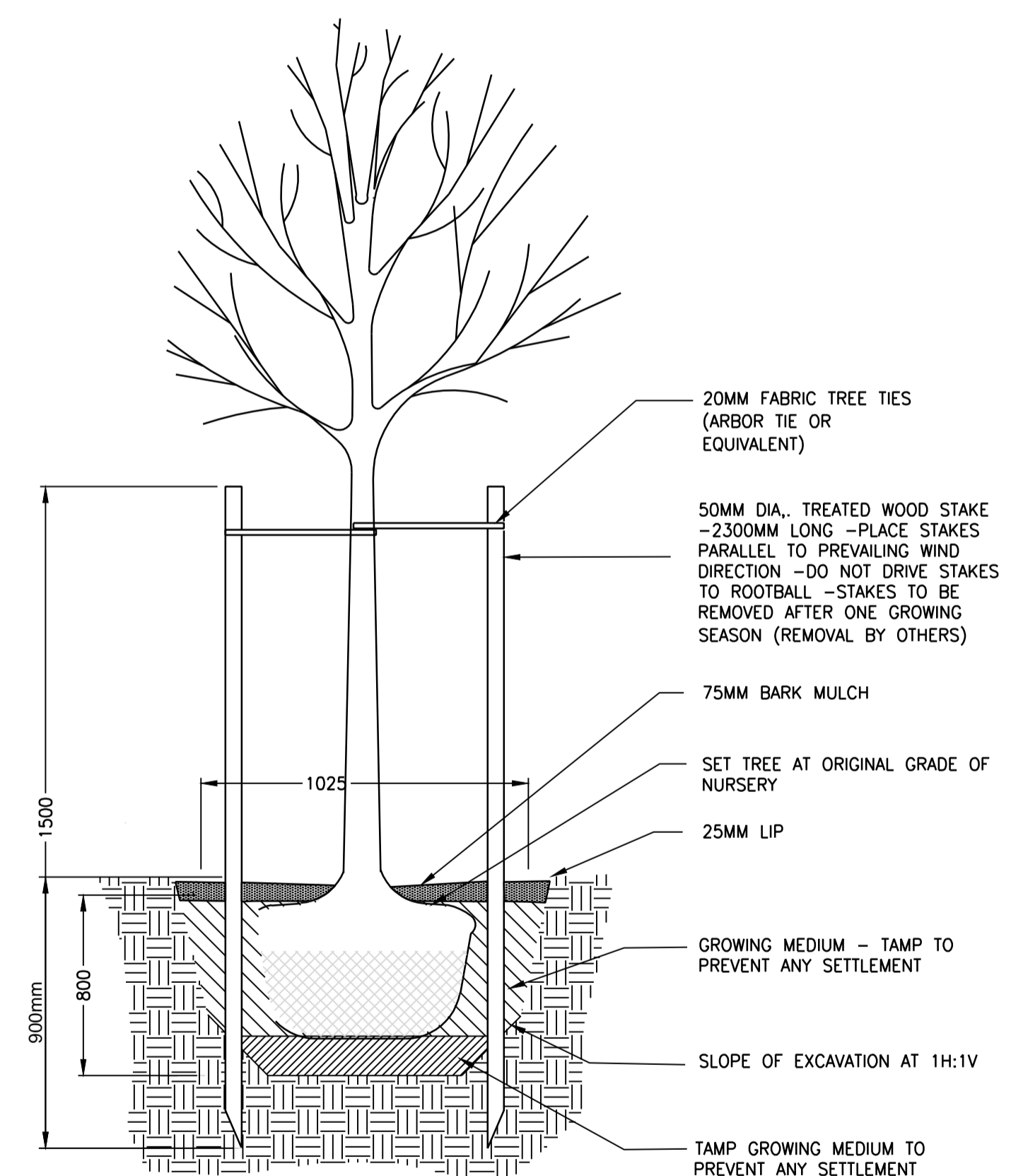

2 Tree Planting - typical
L01 SECTION NTS

No.	DATE	REVISION	ENGR	EXISTING	PROPOSED	EXISTING	PROPOSED	NOTES
A	JULY 8, 2011	ISSUED FOR REVIEW	JESP	MANHOLE	PROPERTY LINE	ROAD CURB		
B	AUGUST 30, 2011	ISSUED FOR QUOTES	JESP	CLEANOUT	SEWER	FORCEMAIN		
				CATCHBASIN	DRAIN	WATER		
				DITCH	H/T/C	GAS		
				CULVERT	DRIVEWAY	TOP SLOPE		
				OUTLET	BOTTOM SLOPE	NOPOST		
				SILT TRAP	NOPOST	FENCE		
				VALVE				
				HYDRANT				
				WATER METER				
				POLE				
				LUMINAIRE				
				TRAFFIC LIGHT				
				MONUMENT				

NOTE: DRAWING TO SCALE ONLY WHEN PLOTTED AT FULL SIZE: A1 (594x841mm) COPYRIGHT OF THIS DRAWING RETAINED BY 1ST TEAM CONSULTING LTD., APPLY FOR PERMISSION TO USE ANY PORTION.

ENGINEER	DESIGN	CLIENT	TITLE
	GM/DAH	CITY OF DUNCAN	PLAYGROUND EXPANSION PLAN
CHECKED	SP	PROJECT	1 st Team Consulting Ltd. Suite 206 2728 Spencer Road, Victoria, B.C. V9B 4C6 tel (250) 478 8383 fax (250) 478 8101 Civil Engineering • Land Planning Landscape Architecture • Project Management
DATE	JAN. 2010	CENTENNIAL PARK PHASE 2	DRAWING NO. 322-07-L01
SCALES	0 1:200 8		SHEET 1 OF 2
			REV B

P:\322-07 PLAYGROUND ADDITION\3 DRAWINGS\3.1 WORKING\322-07-BASE PROPOSED PLAYGROUND FINAL.DWG User: Gene Mazzo Doc A1: 594x841 mm Layout: LANDSCAPE 8/30/2011 9:27 AM

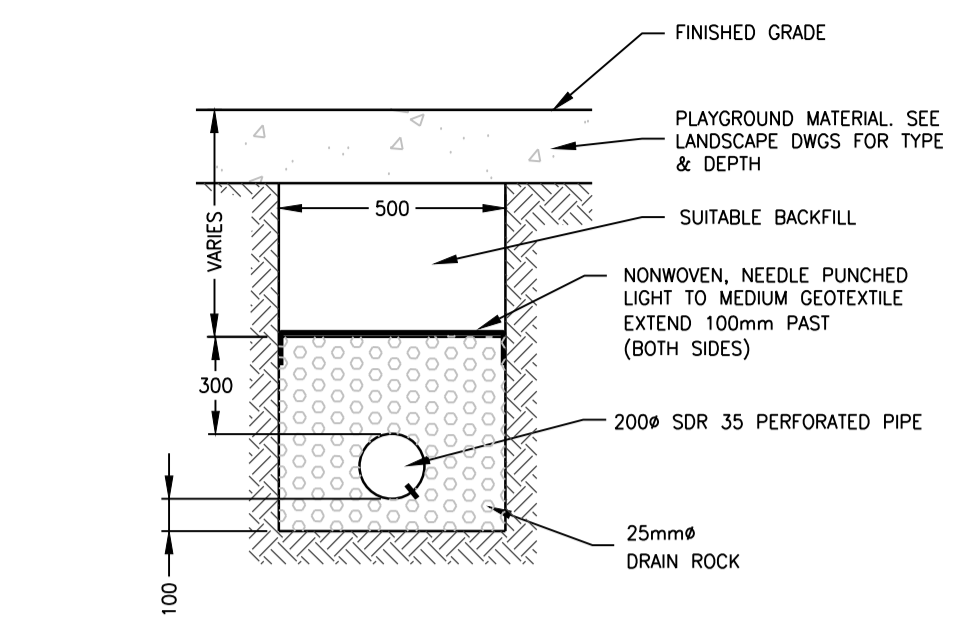
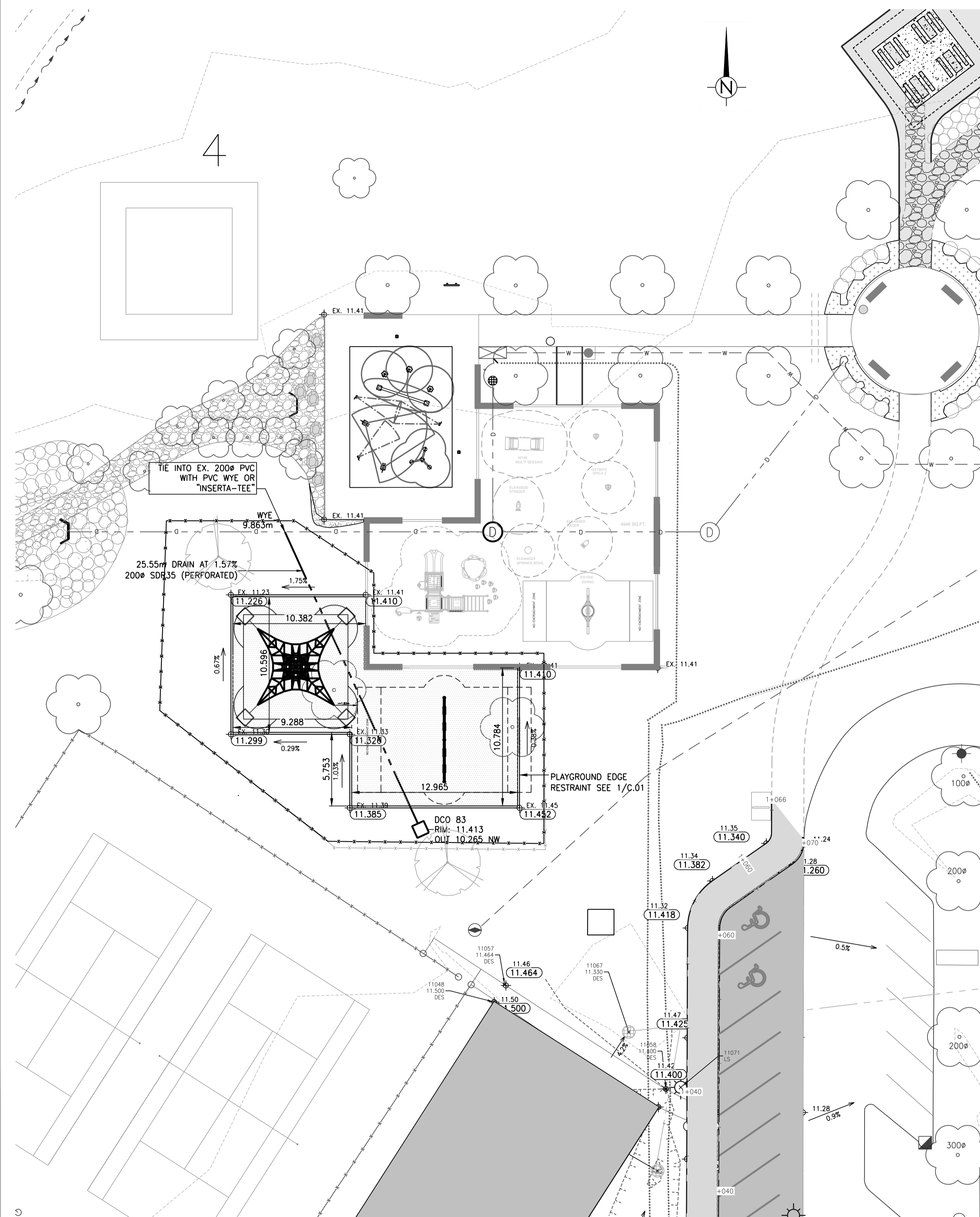

PERFORATED DRAIN PIPE TRENCH DETAIL
N.T.S.

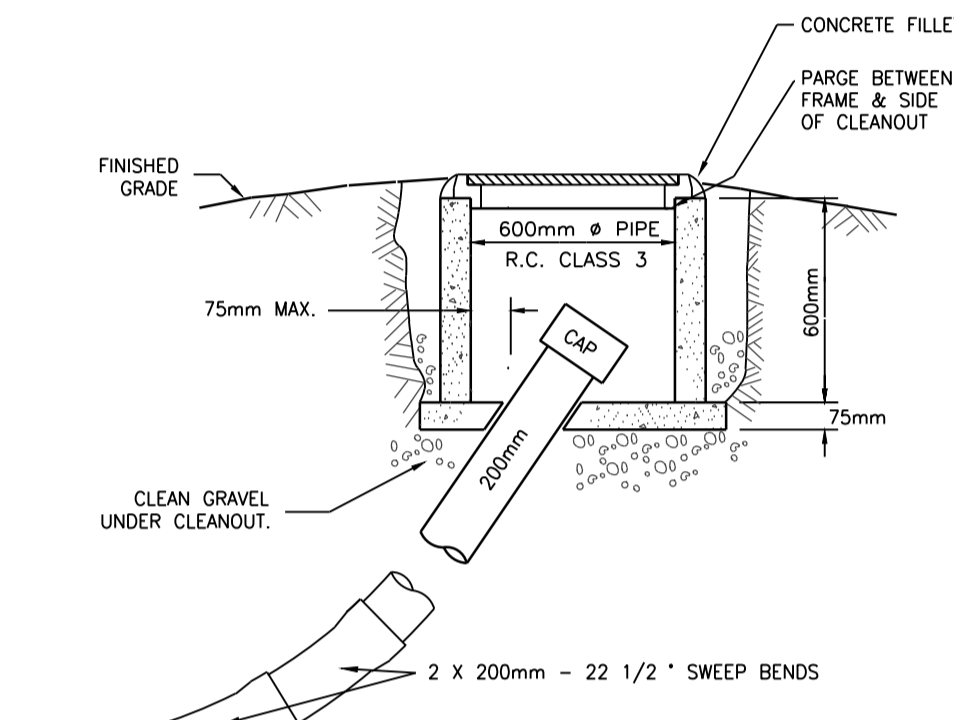

CLEANOUT DETAIL
N.T.S.

- NOTE:
 1. CONCRETE STRENGTH TO BE 32 MPA
 2. CONTROL JOINTS TO BE PLACED 3000mm O.C.
 3. EXPANSION JOINTS TO BE PLACED 6000mm O.C.

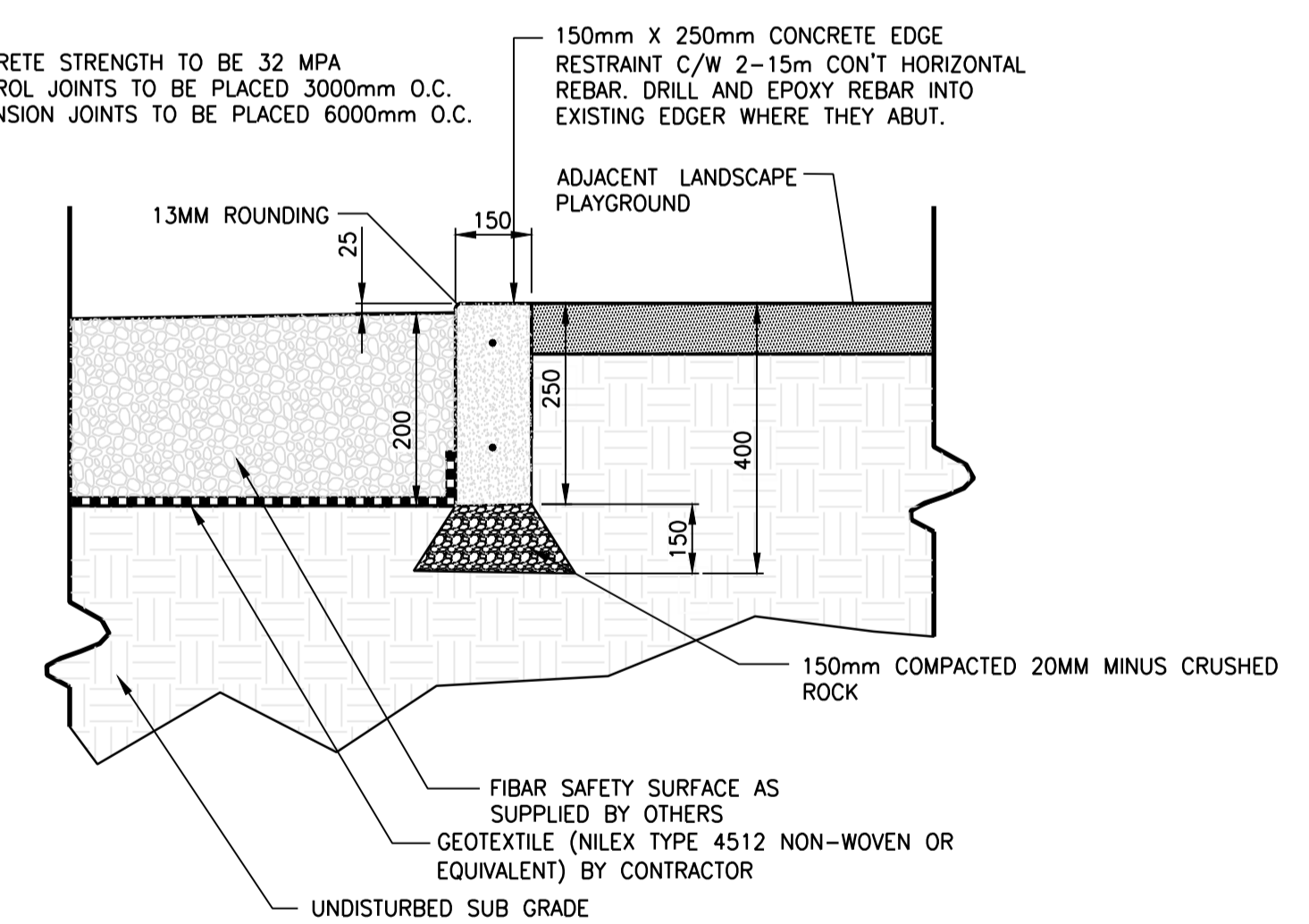

1 Playground Edge Restraint - typical
C.01 SECTION N.T.S.

NOTE: DRAWING TO SCALE ONLY WHEN PLOTTED AT FULL SIZE: A1 (594x841mm) COPYRIGHT OF THIS DRAWING RETAINED BY 1ST TEAM CONSULTING LTD., APPLY FOR PERMISSION TO USE ANY PORTION.

No.	DATE	REVISION	ENGR
A	JULY 07, 2011	ISSUED FOR REVIEW	JESP
B	AUGUST 30, 2011	ISSUED FOR QUOTES	JESP

EXISTING	PROPOSED	EXISTING	PROPOSED
MANHOLE	MANHOLE	PROPERTY LINE	PROPERTY LINE
CLEANOUT	CLEANOUT	ROAD CURB	ROAD CURB
CATCHBASIN	CATCHBASIN	SEWER	SEWER
DITCH	DITCH	FORCEMAIN	FORCEMAIN
CULVERT	CULVERT	DRAIN	DRAIN
OUTLET	OUTLET	WATER	WATER
SILT TRAP	SILT TRAP	H/T/C	H/T/C
VALVE	VALVE	GAS	GAS
HYDRANT	HYDRANT	DRIVEWAY	DRIVEWAY
WATER METER	WATER METER	TOP SLOPE	TOP SLOPE
POLE	POLE	BOTTOM SLOPE	BOTTOM SLOPE
LUMINAIRE	LUMINAIRE	NOPOST	NOPOST
TRAFFIC LIGHT	TRAFFIC LIGHT	FENCE	FENCE
MONUMENT	MONUMENT		

NOTES

ENGINEER	DESIGN	CLIENT
	AKS	CITY OF DUNCAN
	AKS	
	SP	
	JULY 2011	CENTENNIAL PARK

TITLE
PLAYGROUND EXPANSION PLAN

DRAWING NO.	SHEET	REV
322-07 - C.01	2 OF 2	B

1st Team Consulting Ltd.
 Suite 206 2728 Spencer Road,
 Victoria, B.C. V9B 4C6
 tel (250) 478 8383
 fax (250) 478 8101

Civil Engineering • Land Planning
 Landscape Architecture • Project Management

P:\322-07 PLAYGROUND ADDITIONAL DRAWINGS\1.1 WORKING\322-07 DESIGN - GRADING & SERVICES.DWG User: Gene Mozza Doc: A1 15446841 mm Layout: LAYOUT2 8/30/2011 9:27 AM