



ADDENDUM No. 2

REQUEST FOR QUOTATION #2025-01

SEWER CCTV

Date: February 21, 2025

This addendum forms part of the Contract Documents and shall be read, interpreted, and coordinated with all other parts. The costs of all work contained herein shall be included in the RFQ submission. The following revisions, clarifications, changes, additions, or deletions supersede the information contained in the original Documents to the extent referenced and shall become part thereof.

Addendum Items – Work to be completed before January 2026:

- 1) Schedule of Quantities for Inset D1 and Provisional Work Inset D2 to D7
- 2) Site Plan D – Includes Inset D1 to D7
- 3) RFQ Submission extended two weeks to March 12, 2025

Addendum No. 2 is issued prior to receipt of quotes and shall form part of the RFQ documents. The revisions shall supersede information contained in the original RFQ Documents. Proponents must note receipt of this addendum below and attach this page to the proposal submission package.

Addendum No. 2 received.

Name of Proponent

CITY OF DUNCAN
200 Craig Street
Duncan, B. C.
V9L 1W3

SCHEDULE OF QUANTITIES

Inset D1

#	DESCRIPTION	UNIT	QUANTITY	RATE	SUB-TOTAL
1.	Traffic Control	Lump Sum	1		
2.	Mobilization	Lump Sum	1		
3.	Pipe Preparation >450mm	Lineal Meter	880		
	Pipe Preparation 150-450mm	Lineal Meter	283		
4.	Root Cutting	Lineal Meter	254		
5.	Crew and Equipment Rate for Bypass Pumping*	Lump Sum	1		
6.	CCTV – Crawler >450mm	Lineal Meter	880		
	CCTV – Crawler 150-450mm	Lineal Meter	283		
7.	CCTV – Push Cam <150mm	Lineal Meter	104		
				TOTAL	

*if required

Provisional Work

#	DESCRIPTION	UNIT	RATE
1.	Traffic Control	Lump Sum	
2.	Mobilization	Lump Sum	
3.	Pipe Preparation >450mm	Lineal Meter	
	Pipe Preparation 150-450mm	Lineal Meter	
4.	Root Cutting	Lineal Meter	
5.	Crew and Equipment Rate for Bypass Pumping*	Lump Sum	
6.	CCTV – Crawler >450mm	Lineal Meter	
	CCTV – Crawler 150-450mm	Lineal Meter	
7.	CCTV – Push Cam <150mm	Lineal Meter	
TOTAL			

*If required

Instruction to Bidders:

The successful bidder is responsible for supplying all materials, equipment, labour, security, and all equipment required. As well as disposal of all excavated material and all other deleterious materials.

Site Plan D
1:250



Inset D.1
1:1000

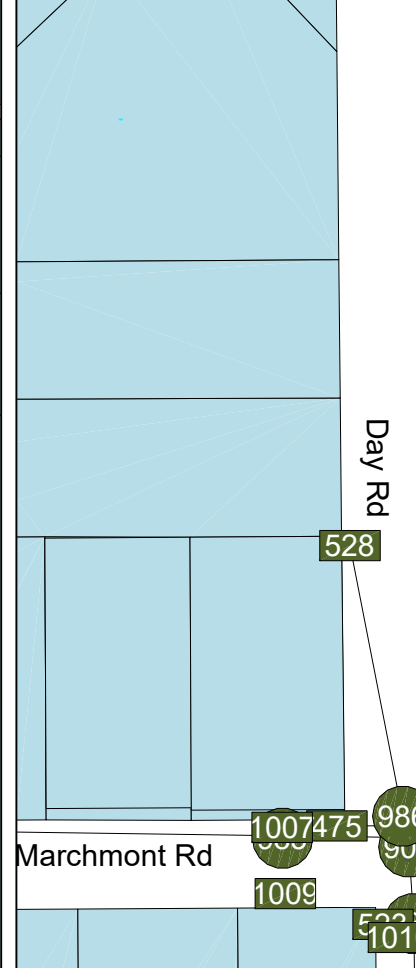

Inset D.5
1:400

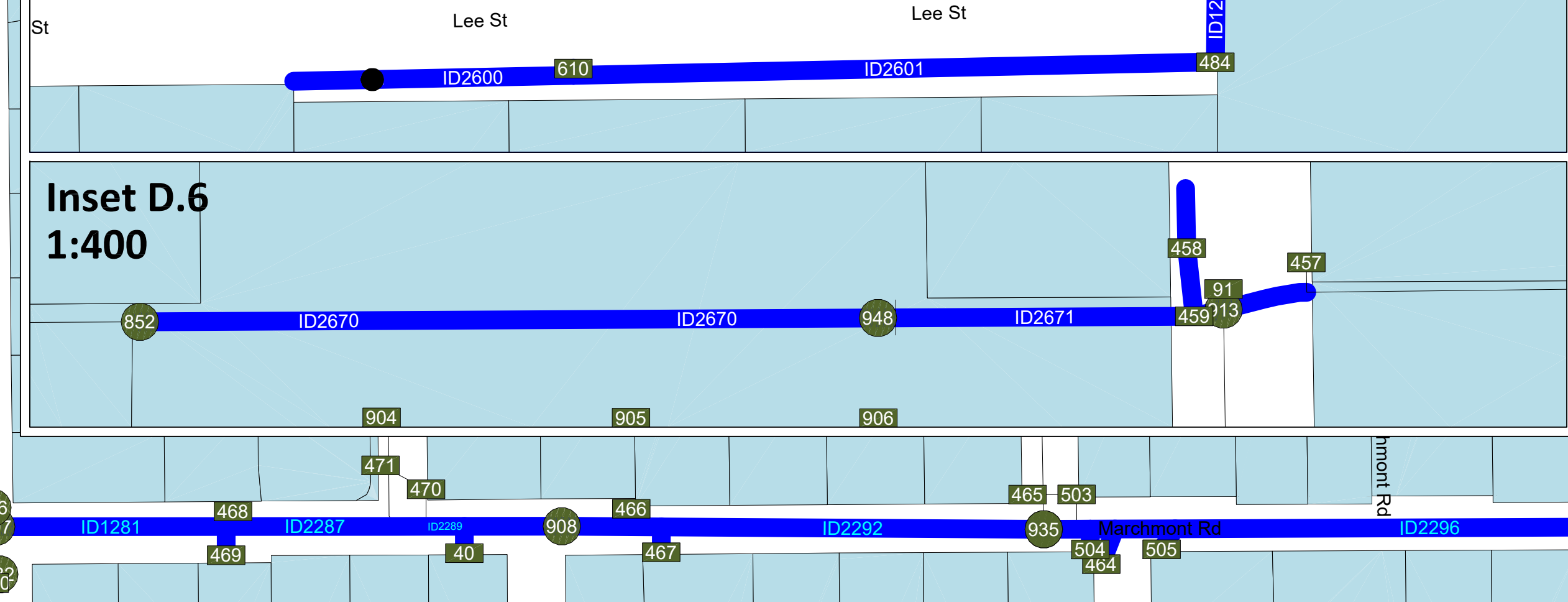

Inset D.6
1:400

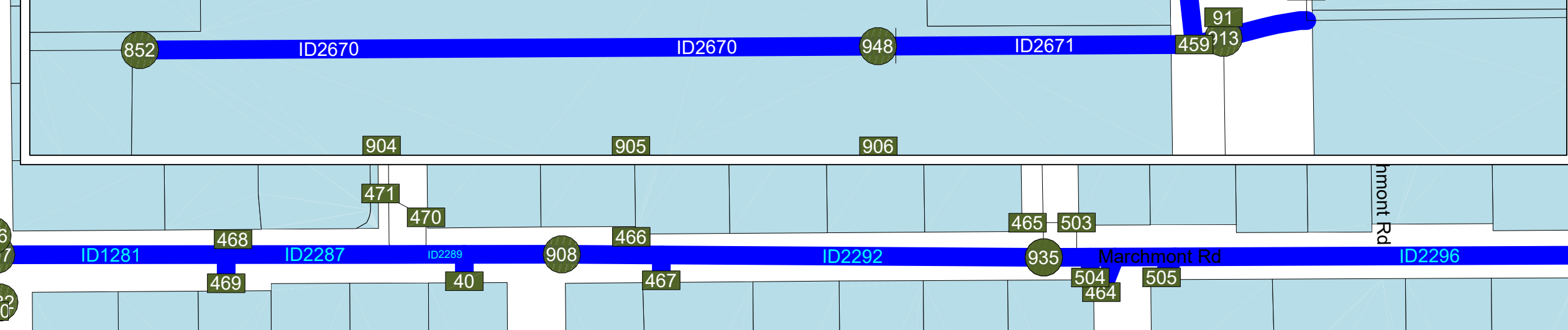

Inset D.2
1:250

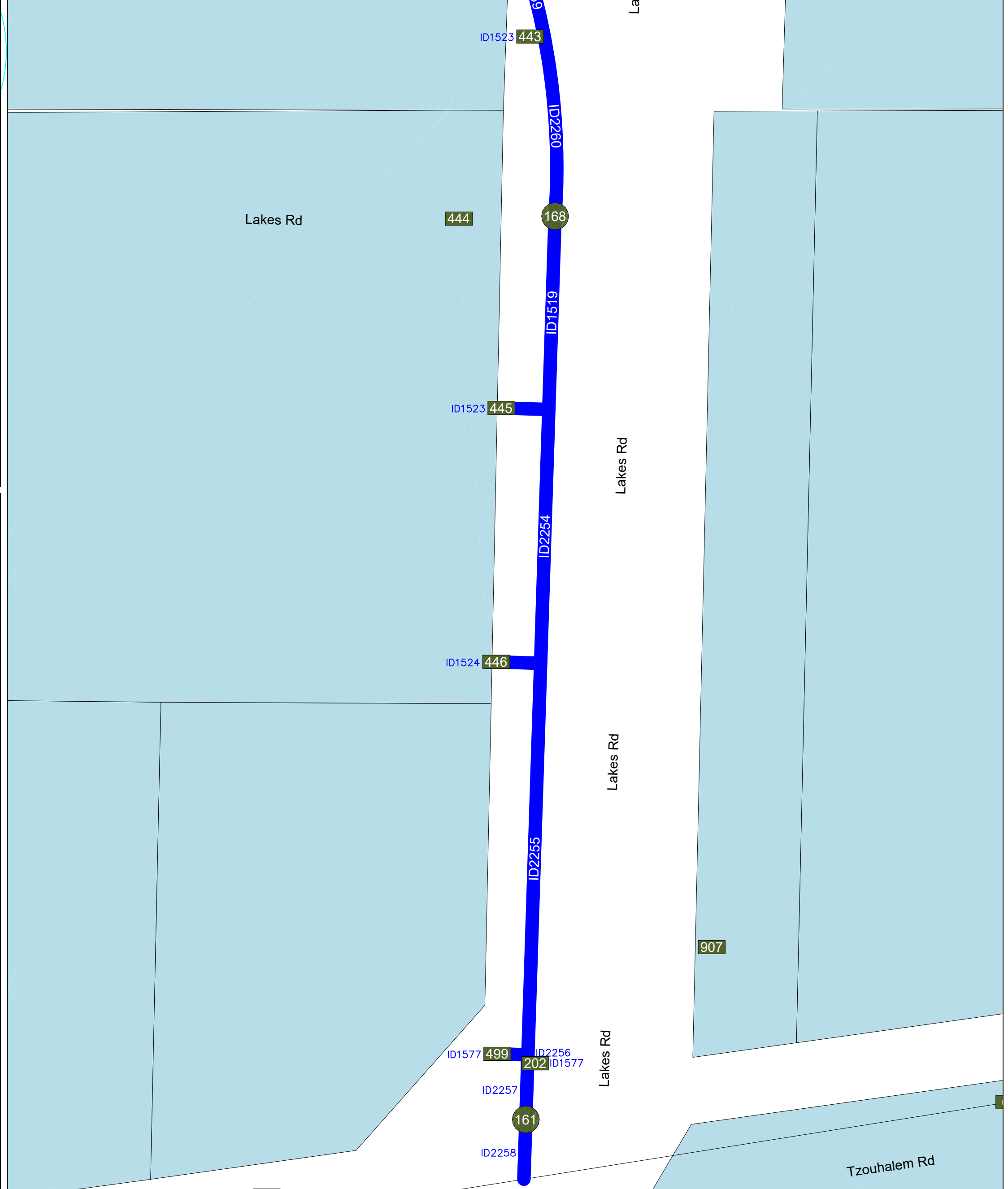

Inset D.7
1:500

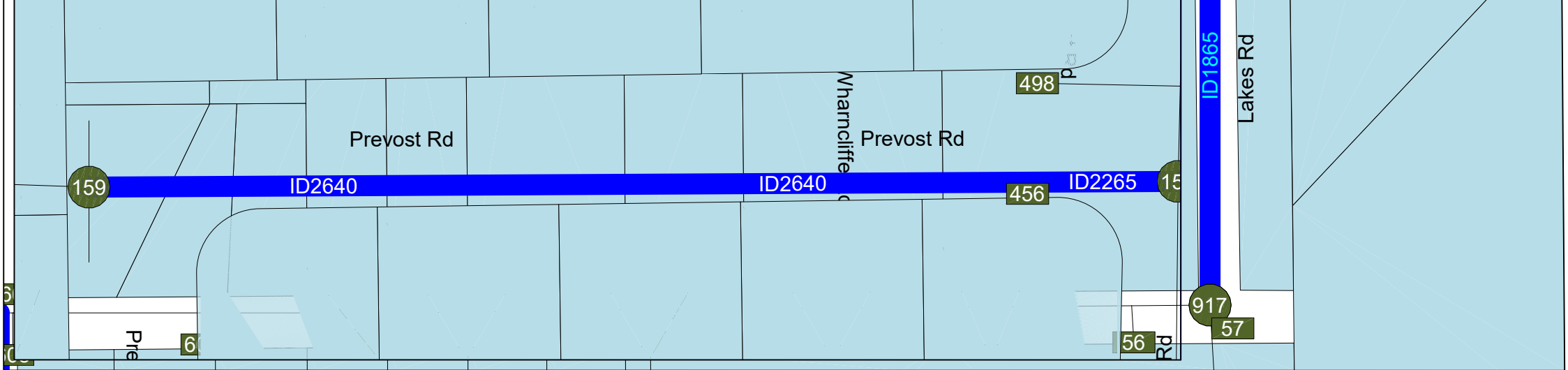

Inset D.3
1:500



Inset D.4
1:400

